

TERREO – ARMADURA POSITIVA HORIZONTAL

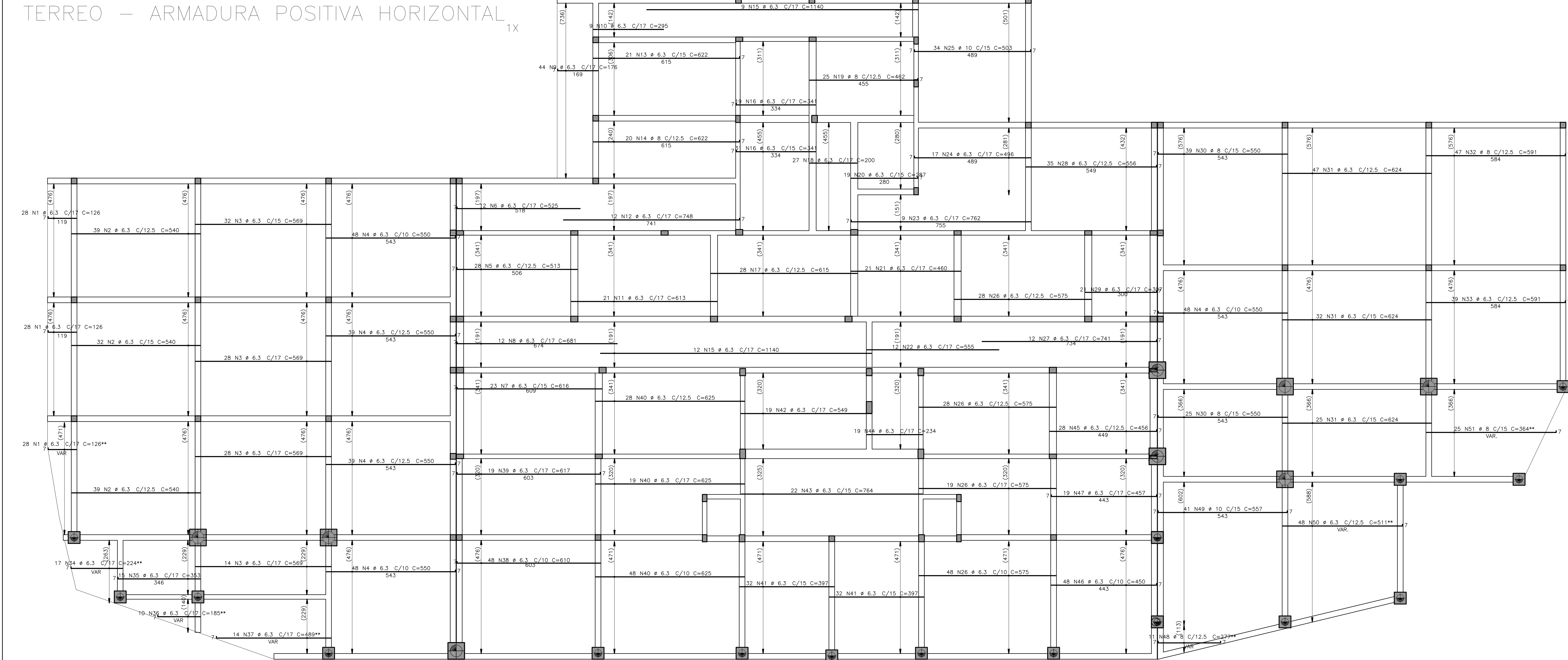

TERREO – ARMADURA POSITIVA VERTICAL

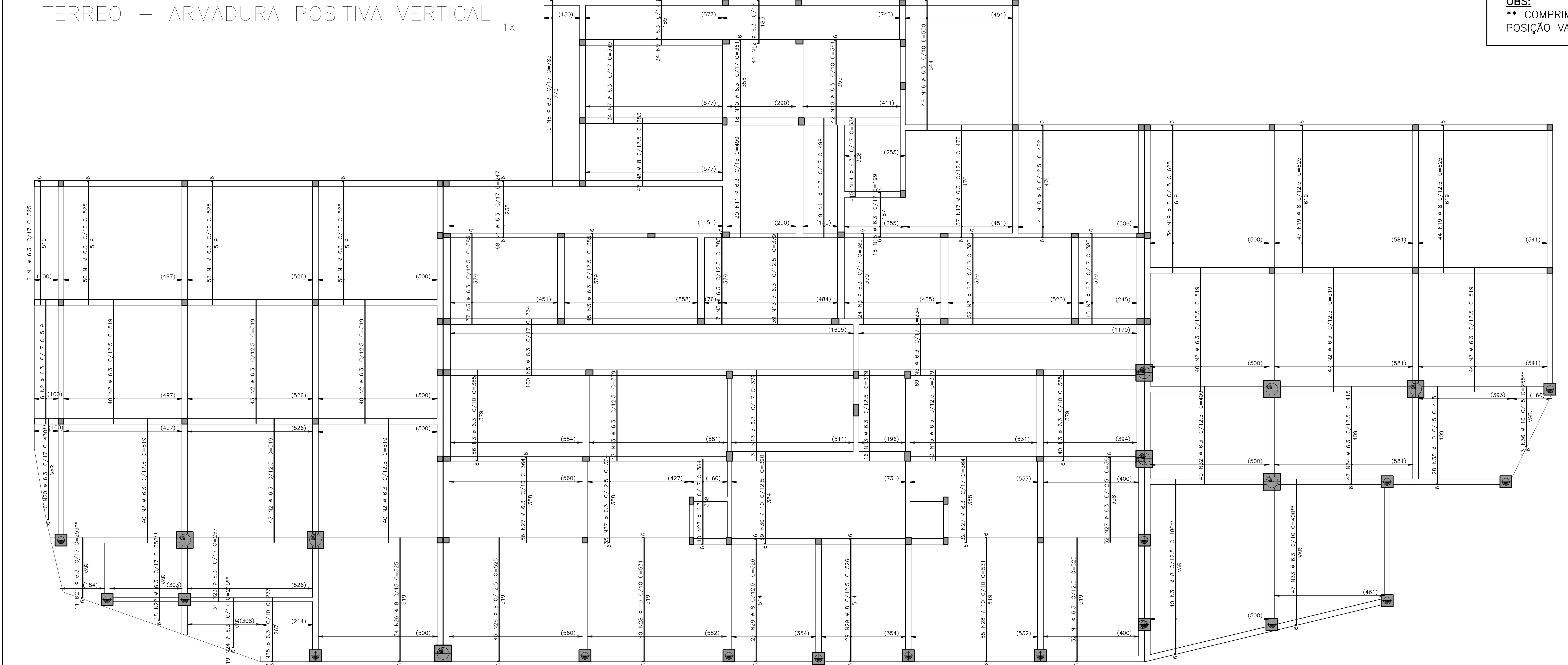

OBS:  
\*\* COMPRIMENTO MÉDIO DO FERRO PARA  
POSIÇÃO VARIÁVEL – OBEDECER COTA

ACO	POS	BIT	QUANT	COMPRIMENTO	UNIT	TOTAL
				(cm)	(cm)	
TERREO – ARMADURA POSITIVA HORIZONTAL						
SOA	1	6.3	84	126	10584	
SOA	2	6.3	110	540	59400	
SOA	3	6.3	102	569	58038	
SOA	4	6.3	222	550	122100	
SOA	5	6.3	28	513	14364	
SOA	6	6.3	23	616	14168	
SOA	7	6.3	12	681	8172	
SOA	8	6.3	44	176	7744	
SOA	9	6.3	9	295	2655	
SOA	10	6.3	11	613	6743	
SOA	11	6.3	12	748	8976	
SOA	12	6.3	12	622	7464	
SOA	13	6.3	21	622	13062	
SOA	14	6.3	20	622	12440	
SOA	15	6.3	21	622	13062	
SOA	16	6.3	50	341	17050	
SOA	17	6.3	28	615	17220	
SOA	18	6.3	27	200	5400	
SOA	19	6.3	25	462	11550	
SOA	20	6.3	19	287	5453	
SOA	21	6.3	21	460	9660	
SOA	22	6.3	12	555	6660	
SOA	23	6.3	9	762	6858	
SOA	24	6.3	17	496	8432	
SOA	25	10	34	503	17102	
SOA	26	6.3	12	575	6900	
SOA	27	6.3	12	741	8892	
SOA	28	6.3	35	556	19460	
SOA	29	6.3	21	307	6447	
SOA	30	6.3	64	550	35200	
SOA	31	6.3	104	694	64984	
SOA	32	6.3	47	591	27777	
SOA	33	6.3	39	591	23046	
SOA	34	6.3	17	224	3808	
SOA	35	6.3	35	525	18375	
SOA	36	6.3	10	185	1850	
SOA	37	6.3	18	468	8424	
SOA	38	6.3	18	610	10980	
SOA	39	6.3	19	617	11723	
SOA	40	6.3	35	620	21700	
SOA	41	6.3	64	397	25408	
SOA	42	6.3	19	548	10411	
SOA	43	6.3	22	764	16808	
SOA	44	6.3	19	234	4446	
SOA	45	6.3	28	456	12768	
SOA	46	6.3	46	450	20700	
SOA	47	6.3	19	457	8663	
SOA	48	6.3	11	277	3047	
SOA	49	10	41	557	22837	
SOA	50	6.3	48	511	24528	
SOA	51	6.3	25	--VAR--	12620	
TERREO – ARMADURA POSITIVA VERTICAL						
SOA	1	6.3	191	525	100275	
SOA	2	6.3	383	519	198777	
SOA	3	6.3	276	385	106260	
SOA	4	6.3	68	247	16796	
SOA	5	6.3	169	234	39546	
SOA	6	6.3	9	785	7065	
SOA	7	6.3	34	349	11866	
SOA	8	6.3	47	283	13301	
SOA	9	6.3	34	191	6494	
SOA	10	6.3	60	361	21660	
SOA	11	6.3	29	499	14471	
SOA	12	6.3	44	192	8448	
SOA	13	6.3	176	379	66104	
SOA	14	6.3	15	334	5010	
SOA	15	6.3	159	199	31645	
SOA	16	6.3	46	550	25300	
SOA	17	6.3	476	17612	83812	
SOA	18	6.3	41	482	19762	
SOA	19	6.3	125	605	75625	
SOA	20	6.3	6	430	2580	
SOA	21	6.3	11	258	2838	
SOA	22	6.3	18	302	5436	
SOA	23	6.3	31	267	8277	
SOA	24	6.3	19	215	4085	
SOA	25	6.3	22	273	6006	
SOA	26	6.3	79	525	41470	
SOA	27	6.3	165	364	60060	
SOA	28	6.3	115	610	70155	
SOA	29	6.3	58	526	30508	
SOA	30	6.3	59	380	22510	
SOA	31	6.3	40	--VAR--	28200	
SOA	32	6.3	40	409	16360	
SOA	33	6.3	47	--VAR--	27401	
SOA	34	6.3	47	415	19525	
SOA	35	10	28	415	11620	
SOA	36	10	13	255	3315	

RESUMO AÇO CA 50-60			
ACO	BIT	COMPR	PESO
(mm)	(cm)	(m)	(kg)
SOA	6.3	16782	4111
SOA	8	3140	1240
SOA	10	1389	857
Peso Total		SOA =	6209 kg

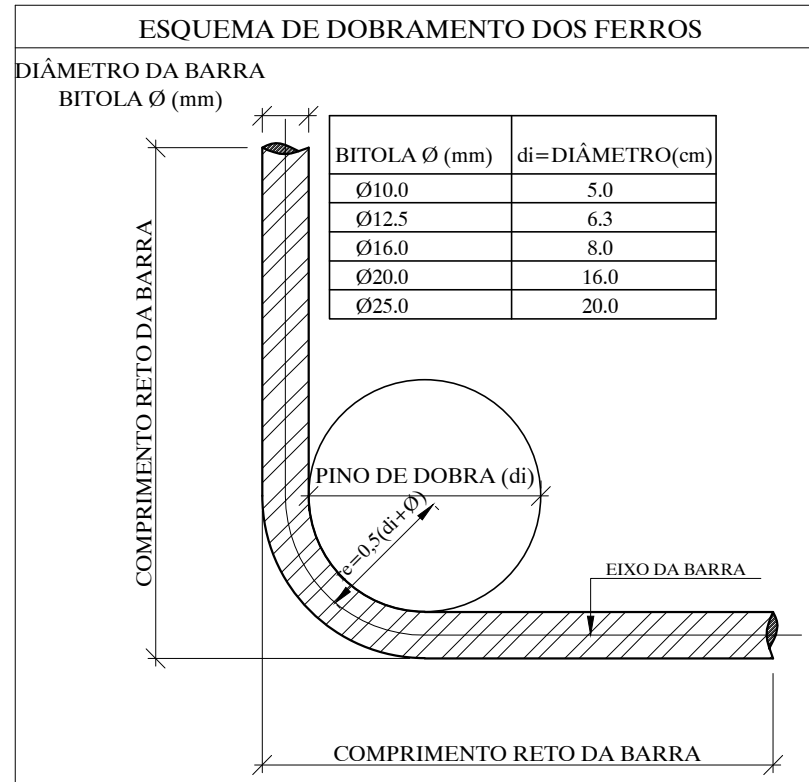

ESCALA

VIGAS:  
--VISTA 1:50  
--CORTE 1:25

LAJES:  
--TERREO 1:75  
--COBERTURA 1:50

REV.	DATA	DESCRIÇÃO	SECRETARIA MUNICIPAL DE OBRAS DEPARTAMENTO DE ENGENHARIA E ARQUITETURA		PREFEITURA MUNICIPAL DE SANTA LUZIA ADM. DELEGADO CHRISTIANO XAVIER	
00	28/05/21	EMISSION INICIAL	SECRETÁRIO DE OBRAS	BRUNO MÁRCIO MOREIRA ALMEIDA	ETAPA	PROJETO EXECUTIVO
			RESPONSÁVEL TÉCNICO	HUGO KENJI INATOMI	CONTEÚDO DA FRANCHA	UNIDADE BÁSICA DE SAÚDE - NOVO CENTRO ARMAÇÃO - LAJE TERREO - ARMAÇÃO POSITIVA
				CREA/SP 5063373661 D		

NÚMERO	DISCIPLINA	DATA
000	ESTRUTURA	28/05/2021
		08/11
		00